

NC Institutional Galleries

continued from Page 51

casting how the glass will flow, expand, and settle during the heating and cooling cycles. Ultimately, it's a matter of working backwards. Sometimes I get it right and sometimes I don't, but chasing the challenge is what I love most," said Elijah Kell. **Through Dec. 15** - "Paintings by Molly Partyka". "My art is about color play. Like a dance, colors move across the canvas, interacting with shapes and textures. Like notes together form songs and words strung together form stories, I use color to express the exquisiteness of nature and human interaction in an abstract format. Travel and the interplay of dichotomy and harmony are my current themes. Feelings of daydreaming, longing to wander, and thoughts of wistfulness are expressed in the blue-greens of the oceans, grey-blues of skies, and lush greens of fields. Warm reds, oranges, and yellows capture strength of relationships, the energy of movement, and the excitement of growth," said Molly Partyka. Contact: 704/330-6869 or e-mail to (foundation@cpcc.edu) to schedule an appointment. For directions to Central Piedmont's campuses, visit (cpcc.edu/locations).



Work by Romare Bearden

Bill and Patty Gorelick Gallery at Central Piedmont Community College's Central Campus, North Classroom, 1320 Sam Ryburn Walk, Charlotte. **Through Dec. 15** - "Works from the Collection of Judy & Patrick Diamond". Featuring a collection of African American art on loan from influential art collectors, Judy and Patrick Diamond. This vibrant display, a portion of the art and collectibles curated by the Diamonds over a period of 46 years, will be on display through mid-December. The exhibit features art by Romare Bearden such as "Brass Section," the lithograph that ignited the Diamond's passion for collecting African American art. A love of art and the influence it has had on his life led Patrick to write his memoir published in 2020, "The Incredible Joy of Collecting African American Art." Hours: open while campus is open, but reservation help help us alert our security team to visitors, provide directions to the galleries, and COVID-19 security protocol instructions to the visitors. Contact: 704/330-6869 or e-mail to (foundation@cpcc.edu) to schedule an appointment. For directions to Central Piedmont's campuses, visit (cpcc.edu/locations).

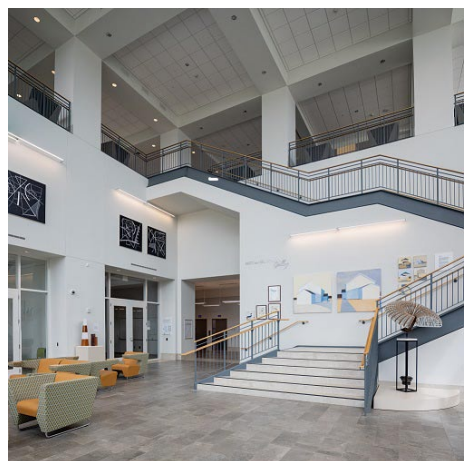

View inside Harper Campus Gallery

Bill and Patty Gorelick Gallery at Central Piedmont Community College's Harper Campus, Harper IV, 315 W. Hebron St., Charlotte. **Through Dec. 15** - "Almost Home," by Tom Delaney. This exhibit explores the home as a visual metaphor and includes Delaney's three-dimensional bird sculptures. **Through Dec. 15** - "The Sculptures of Kevin O'Toole". "Over the past 35 years I have developed an increasingly spare vocabulary of forms. At one time more organic, my pieces have gradually become more geometric through the influence of both process and choice of material," said O'Toole. Hours: open while campus is open, but reservation help help us alert our security team to visitors, provide directions to the galleries, and COVID-19 security protocol instructions to the visitors. Contact: 704/330-6869 or e-mail to (foundation@cpcc.edu) to schedule an appointment. For directions to Central Piedmont's campuses, visit (cpcc.edu/locations).



Works by Judith Ernest

Bill and Patty Gorelick Gallery at Central Piedmont Community College's Harris Campus, Harris II, 3210 CPCC Harris Campus Drive, Charlotte. **Through Dec. 15** - Featuring works by Marvin Espy. Espy's paintings express his love for color by incorporating his passion for the city and representing the spirit of its people. **Through Dec. 15** - Featuring works by Judith Ernst. Ernst creates conceptual and even contemplative ceramic vessels, including new pieces which incorporate words. Hours: open while campus is open, but reservation help help us alert our security team to visitors, provide directions to the galleries, and COVID-19 security protocol instructions to the visitors. Contact: 704/330-6869 or e-mail to (foundation@cpcc.edu) to schedule an appointment. For directions to Central Piedmont's campuses, visit (cpcc.edu/locations).

Bill and Patty Gorelick Gallery at Central Piedmont Community College's Levine Campus, Levine II, 2800 Campus Ridge Road, Matthews. **Through Dec. 15** - "Life Lived in Layers," by Randy Leibowitz Dean. Featuring seven art wood sculptures which represent an ever evolving, very physical, and deeply meditative experience that comprises Randy's artistic process. **Through Dec. 15** - "When Nature Takes Back," by Malu Tan. Tan's paintings show an expression of an intimate relationship with the environment which include bodily colored and textured abstract expressions of nature. Hours: open while campus is open, but reservation help help us alert our security team to visitors, provide directions to the galleries, and COVID-19 security protocol instructions to the visitors. Contact: 704/330-6869 or e-mail to (foundation@cpcc.edu) to schedule an appointment. For directions to Central Piedmont's campuses, visit (cpcc.edu/locations).



Work by Tommie Rush

Bill and Patty Gorelick Gallery at Central Piedmont Community College's Merancas Campus, Merancas IV, 1930 Verhoeff Dr., Huntersville. **Through Dec. 15** - "Frieze," by artist Tom Stanley. Stanley's series are often hung as a frieze even as he works on groups of paintings. Size, imagery, color, and format for each series is distinct and helps to create a visual theme within the group of related works. **Through Dec. 15** - "Art on Loan from the Collection of Dr. Larry Brady and Mr. Roman Matso". The 18 pieces exhibited represent a broad and diverse range from Brady's eclectic selection of paintings, engravings, photographs, furniture and sculptures. Brady enjoys living with each piece of art in his collection and sharing them with as many people as possible. Hours: open while campus is open, but reservation help help us alert our security team to visitors, provide directions to the galleries, and COVID-19 security protocol instructions to the visitors. Contact: 704/330-6869 or e-mail to (foundation@cpcc.edu) to schedule an appointment. For directions to Central Piedmont's campuses, visit (cpcc.edu/locations).

Bliss Gallery, established by Holy Angels, 25 N. Main Street, Belmont. **Ongoing** - Holy Angels established Bliss Gallery to offer persons who are differently able the opportunity to share creative abilities and showcase their art alongside the works of guest artists during special exhibitions. Hours: Wed.-Sat., noon-4pm. Contact: Harmony Heslop at 704/280-9475, e-mail at (blissgallery@holyangelsnc.org) or visit (www.holyangelsnc.org).

Charlotte Art League Gallery & Studios, 4237 Raleigh Street, Charlotte. **Ongoing** - CAL houses one of the area's largest collections of local professional and emerging artists, offering affordable fine art in a variety of styles and media: acrylics, oil, pastel, watercolor, mixed media, photography and sculpture, and fiber art. Tour studios of working artists. Admission: Free. Hours: Thur.-Fri., 11am-3pm & Sat.-Sun., noon-4pm. Contact: 704/376-2787 or at (www.charlotteartleague.org).

Davidson College, Belk Visual Arts Center, 315 North Main and Griffith Streets, Davidson. **Van Every/Smith Galleries, Through Dec. 9** - "Nicholas Galanin: Dreaming in English". Galanin's work is rooted in his perspective as an Indigenous man, deeply connected to the land and his Tlingit/Unangax culture. Over the past two decades, Galanin has worked across media, materials, and processes—engaging past, present, and future—to expose widespread misappropriation and commodification of Indigenous visual culture, the impact of colonialism, intentionally obscured collective memory, and barriers to education. His practice, encompassing sculpture, installation, photography, video, performance, printmaking, and textile-based works, unites traditional and contemporary processes and materials to reclaim narrative and creative agency, and contribute to the continuum of Tlingit art within an ever-evolving contemporary Indigenous practice. His exhibition at the Van Every/Smith Galleries, "Dreaming in English", includes an installation of the same title that speaks directly to the forced removal and relocation of Indigenous children from the reservation into residential "schools." These so-called "schools" were not focused on the acquisition of knowledge but on assimilation; the intent was to eradicate both culture and spirit. **Ongoing** - While on campus, be sure to take a tour of our Campus Sculpture. Hours: Mon.-Fri., 10am-5pm and Sat. & Sun., noon-4pm. Contact: 704/894-2519 or at (www.davidsoncollegeartgalleries.org).



Work by Al Torres

Elizabeth Ross Gallery, Central Piedmont Community College, Central Campus, Overcash Performing Arts Center, Elizabeth Avenue and Kings Dr., Charlotte. **Through Dec. 9** - "Metamorphosis II," an exhibition of multi-view paintings by CPCC Art Instructor Al Torres, that go beyond the physical presence of a person or object. A reception will be held on Nov. 3, at 5:30pm in Central Campus, Overcash Center, Ross Art Gallery, 1st floor. An Artist Lecture will be offered on Nov. 3, at 2pm, at Central Campus, Overcash Center, Tate Hall, 2nd floor. Torres aims to capture the "truth" of the subject and impart a sense of wonder to the viewer. Torres paints directly onto aluminum surfaces at 45 degrees. The intent is for the spectator to approach the work from the left side, where he or she sees the first image. As they walk toward the center, they encounter a combination of the left and right views. These multiple views help the spectator transition through the story of the overall painting. Watch a six minute video of Al Torres' works in this exhibit at (<https://youtu.be/cwSgQM5RXpw>). Hours: Mon.-Thur., 10am-2pm. Contact: 704/330-6211.

Harvey B. Gantt Center for African-American Arts & Culture, Levine Center for the Arts, 551 S. Tryon St., Charlotte. **Through Jan. 17, 2022** - "Container / Contained: Phil Freelon - Design Strategies for Telling African American Stories". The late North Carolina architect Philip G. Freelon (1953-2019) had a remarkable career of over four decades designing public buildings with his firm The Freelon Group and later as Design Director of Perkins + Will North Carolina. This exhibition critically examines Freelon's work, including museums, libraries, cultural centers, and public parks, with a focus on projects that foreground African American communities and identities. Freelon often noted that architecture should be more than a container, that it should help tell the story of and be integral to the content of these public institutions. **Through Jan. 17, 2022** - "Visual

Vanguard: An Exhibition of Contemporary Black Carolina Artists". The exhibition is an examination of twenty-six artists who create in a variety of vibrant and versatile media. This exhibition surveys the struggles, strengths, and celebrations of Black creativity in the Carolinas through visual art, performance, video, and poetry. By examining the ambiguity and origination within retakes and variations, each artist amplifies the ideals of racial pride, social power, identity, and the importance of heritage and culture. Guest curators, David Wilson and Stephen Hayes, Jr., sought a mosaic of styles that range from didactic to reductive. Their collective vision provides a framework for significations that are inverted and opportunities where form and content merge. Consideration was given to content that is disassociated from its original meaning, ultimately exposing the artist's process. Artists with works in the exhibition include: Carla Aaron-Lopez, Endia Beal, Dare Coulter, Steven M. Cozart, de'Angelo Dia, Janelle Dunlap, André Leon Gray, Clarence Heyward, Percy King, Marcus Kiser, KOLPEACE, Georgie Nakima, Dimeji Onafuwa, Jermaine Powell, Lakeshia T. Reid, Sheldon Scott, Beverly Y. Smith, William Paul Thomas, J. Stacy Utley, Telvin Wallace, Torrea "Cookie" Washington, Tony Weaver, Aniqua Wilkerson, Antoine Williams, Jason Woodberry, and Stephanie J. Woods. **Ongoing** - Featuring selections from the John & Vivian Hewitt Collection of African-American Art, one of the nation's most important and comprehensive collections of African-American art. Hours: Thur. - Sat., noon-6pm & Sun., noon-6pm. Extended hours from noon-8pm on Fridays, Oct. 2, Nov. 6 & Dec. 4. Contact: 704/547-3700 or at (www.ganttcenter.org).

Lake Norman Art League Gallery, 442 S. Main St., located across the street from Wooden Stone, next to Masterworks; enter at the rear of the building, and turn right into the lobby, Davidson. **Ongoing** - Featuring works by Lake Norman Art League members. Hours: Mon.-Fri., 8am-7pm. Contact: 704/620-4450 or at (www.LKNart.org).

Lamba Gallery, Storrs Building, 100, 9201 University City Blvd. UNC Charlotte Main Campus, Charlotte. **Through Dec. 6** - "Michael Swisher, A Retrospective," featuring a celebratory exhibition of the 30-year career of Associate Professor of Architecture Emeritus Michael Swisher. Hours: Mon.-Fri., 9am-5pm. Contact: 704/687-2397.

Latin American Contemporary Art Projects (LaCa), 1429 Bryant Street, in the heart of the revitalized FreeMoreWest neighborhood, Charlotte. **Ongoing** - LaCa Projects is a platform dedicated to the presentation, development, and promotion of Latin American art and culture within the United States. The gallery encourages cross-cultural dialogue by representing a small group of influential and thought-provoking contemporary, emerging and mid-career artists, as well as exhibiting a broader range of work by established and Master Latin American artists. The gallery, which has expertise in a number of different art media with a significant focus on paintings, will also be part of a larger planned expansion that includes open artist studios and a dining concept. Hours: Mon.-Fri., 1-5pm or by appt. Contact: Neely Verano at (neely@lacaprojects.com) or call 704/609-8487.

Levine Museum of the New South, 200 E. Seventh St., corner of College St & Seventh St., Charlotte. **Ongoing** - "Cotton Fields to Skyscrapers," featuring a permanent exhibition featuring interactive environments that trace the history of the New South from the end of the Civil War until today. Admission: Yes. Free on Sat. Parking: next door in Seventh Street Station. Hours: Mon.-Sat., 10am-5pm & Sun., noon-5pm. Contact: 704/333-1887 or at (www.museumofthenewsouth.org).

McDowell Arts Center, 123 McDowell Street, located adjacent to the Matthews Community Center, Matthews. **Through Nov. 5** - "Fall Art Show 2021," featuring works by members of the Guild of Charlotte Artists, juried by Nicholas Stewart. The Guild is celebrating its 73rd anniversary, since 1948. Visit (www.guildofcharlotteartists.org) for more info. Hours: Mon.-Fri., 1-8pm; Sat., 10am-4pm; & Sun. 1-6pm. Contact: 704/321-7275.

Mint Museum Randolph, 2730 Randolph Road, Charlotte. **Bridges and Levine Galleries, Ongoing** - "Contemporary British Studio Ceramics: The Grainer Collection". Focused on the collection of Diane and Marc Grainer, this installation is a survey of contemporary British studio ceramics. Comprising functional and sculptural objects made between the 1980s and today, the show features work by artists either born or residing in Great Britain, including established "contemporary classics" like Gordon Baldwin and Rupert Spira, and cutting-edge ceramicists such as Julian Stair and Kate Malone. Several recently-gifted

continued on Page 53